



24 KATHERINE WAY, SEAFORD, EAST SUSSEX, BN25 2UZ

£525,000



This well-presented three bedroom (formerly a four bedroom) detached house with traditional Sussex-style half tile hung walls, offers generous living accommodation and further benefits from a good size garden. Nestled in a sought-after area near scenic trails and the South Downs National Park, Seaford offers charming amenities, including its unspoilt beach, railway station and bus services between Brighton and Eastbourne. A local Co-op can conveniently be found within approximately 350 yards. Viewings are recommended to fully appreciate this inviting home.

Downstairs the accommodation comprises a large living room overlooking the rear garden, kitchen/breakfast room, dining room and a cloakroom. Upstairs, there is a family bathroom and three bedrooms, all featuring built-in wardrobes. The master bedroom has an en-suite shower room and the benefit of a walk-in wardrobe which was formerly the fourth bedroom.

Outside, the sizable garden boasts mature beds, a patio, a summerhouse with decking, shed, lawn and secure side access. The front garden is laid to lawn with a block brick driveway providing parking in front of the garage.

- THREE (FORMERLY FOUR) BEDROOM DETACHED HOUSE
- SITUATED IN A QUIET AREA
- SPACIOUS LIVING ROOM
- KITCHEN/BREAKFAST ROOM
- DINING ROOM
- EN-SUITE AND DRESSING ROOM TO MAIN BEDROOM
- FAMILY BATHROOM
- SOUTH EASTERLY ASPECT
- REAR GARDEN
- OFF ROAD PARKING
- SINGLE GARAGE



GROUND FLOOR  
67.6 sq.m. (728 sq.ft.) approx.

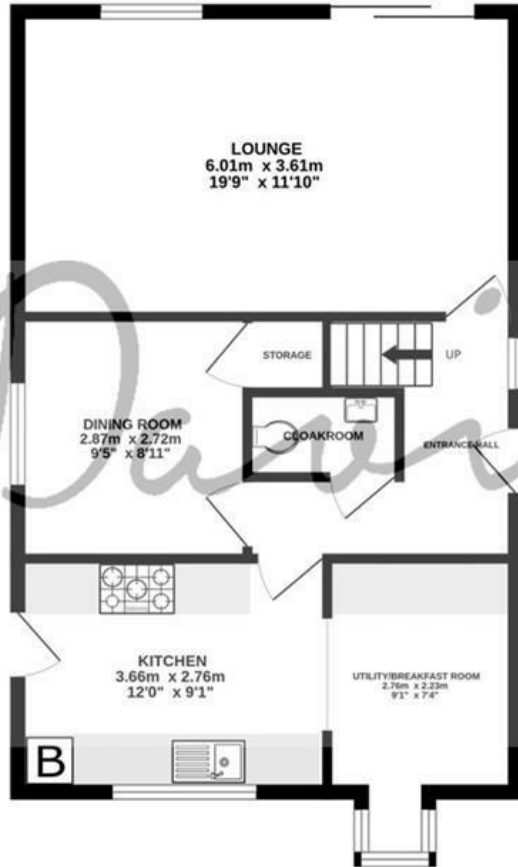

1ST FLOOR  
54.5 sq.m. (586 sq.ft.) approx.

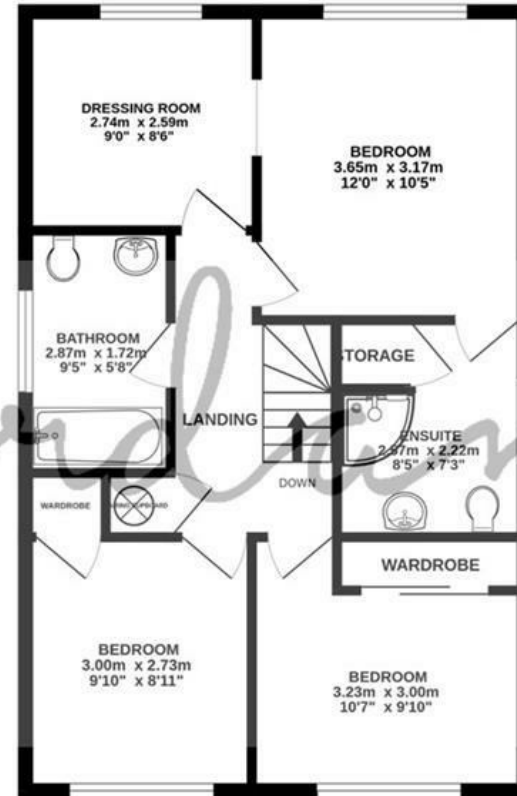

EST. 2004

24 KATHERINE WAY SEAFORD

TOTAL FLOOR AREA: 122.1 sq.m. (1315 sq.ft.) approx.

Whilst every attempt has been made to ensure the accuracy of the floorplan contained here, measurements of doors, windows, rooms and any other items are approximate and no responsibility is taken for any error, omission or mis-statement. This plan is for illustrative purposes only and should be used as such by any prospective purchaser. The services, systems and appliances shown have not been tested and no guarantee as to their operability or efficiency can be given.  
Made with Metropix ©2026





## COUNCIL TAX BAND

Local Authority: Lewes District Council

Council Tax Band: E

## ENERGY PERFORMANCE CERTIFICATES (EPC)

Energy Efficiency Rating: C

## DISCLAIMER

Money Laundering Regulations 2017: Intending purchasers will be asked to produce identification documentation upon acceptance of any offer. We would ask for your cooperation in producing such in order that there will not be a delay in agreeing the sale.

General: Whilst we endeavour to make our sales particulars fair, accurate and reliable they are only a general guide to the property and accordingly if there is any point which is of particular importance to you please contact the office and we will be pleased to check the position for you. Buyers must check the availability of any property and make an appointment to view, before embarking on any journey to see a property. Items shown in photographs are NOT included unless specifically mentioned within the sales particulars. They may however be available by separate negotiation.

Measurements: These approximate room sizes are only intended as general guidance. You must verify the dimensions carefully before ordering carpets or any built in furniture.

Services: Please note we have not tested any apparatus, equipment, fixtures and fittings or services and so cannot verify that they are in working order or fit for the purpose. A Buyer is advised to obtain verification from their Solicitor or Surveyor. References to the Tenure of a Property are based on information supplied by the Seller. The Agent has not had sight of the title documents. A Buyer is advised to obtain verification from their Solicitor. These particulars are issued in good faith but do not constitute representations of fact or form part of any offer or contract.

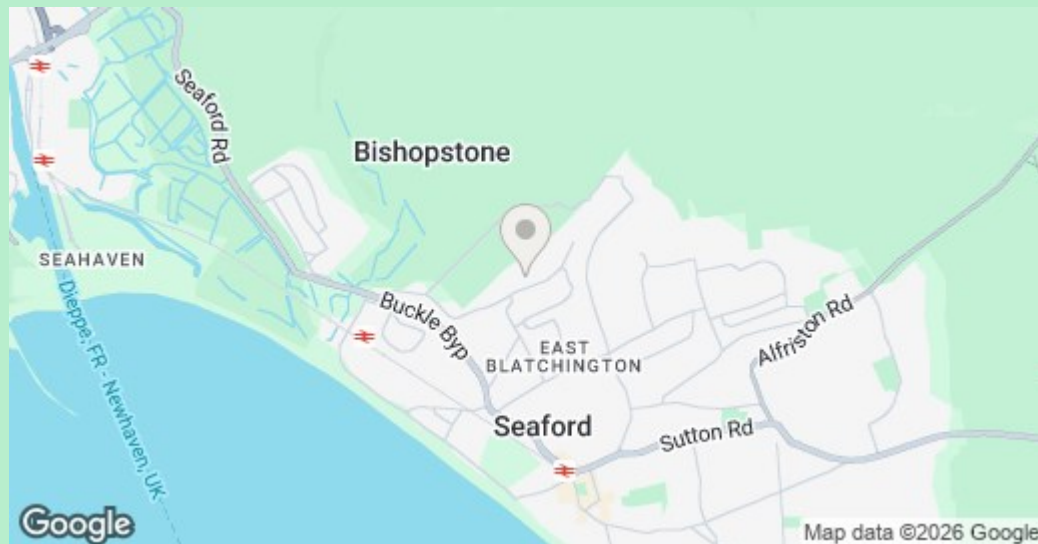

01323 898414

[sales@davidjordan.co.uk](mailto:sales@davidjordan.co.uk)

[davidjordan.co.uk](http://davidjordan.co.uk)

*David Jordan*

EST. 2004